

Notes

- This drawing is to be read in conjunction with all other relevant drawings, details and specifications.
- DO NOT SCALE FROM THIS DRAWING. Use figured dimensions only.
- All dimensions to be confirmed prior to construction.
- Any discrepancies should be reported to Derry Owen Architects at the earliest convenience.

NOTE
Removal of structural elements to be carried out in accordance with a detailed method statement, approved by the Structural Engineer.

Survey undertaken and provided by -

All ecology provisions to be carried out in accordance with ecology report.

Patent glazing in aluminium frames.

New slate roof

Conservation rooflights.

Extg. stonework re-pointed with lime mortar.

P.P.C aluminium windows and doors.

Clay ridge tiles.

Galvanised rainwater goods.

Remove cementitious render and apply new lime wash render finish.

Infill opening with cavity blockwork and render.



Elevation 1 - As Proposed
(1:100)

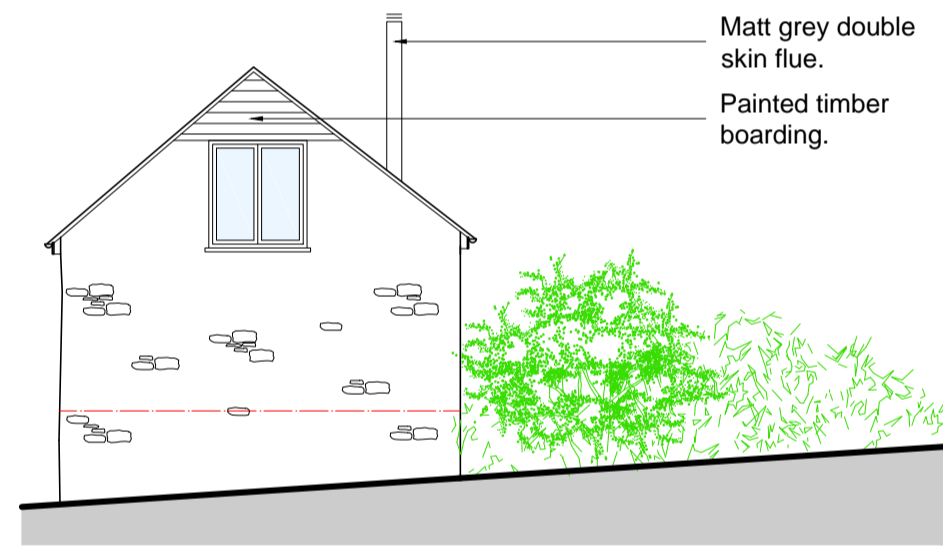

Elevation 2 - As Proposed
(1:100)

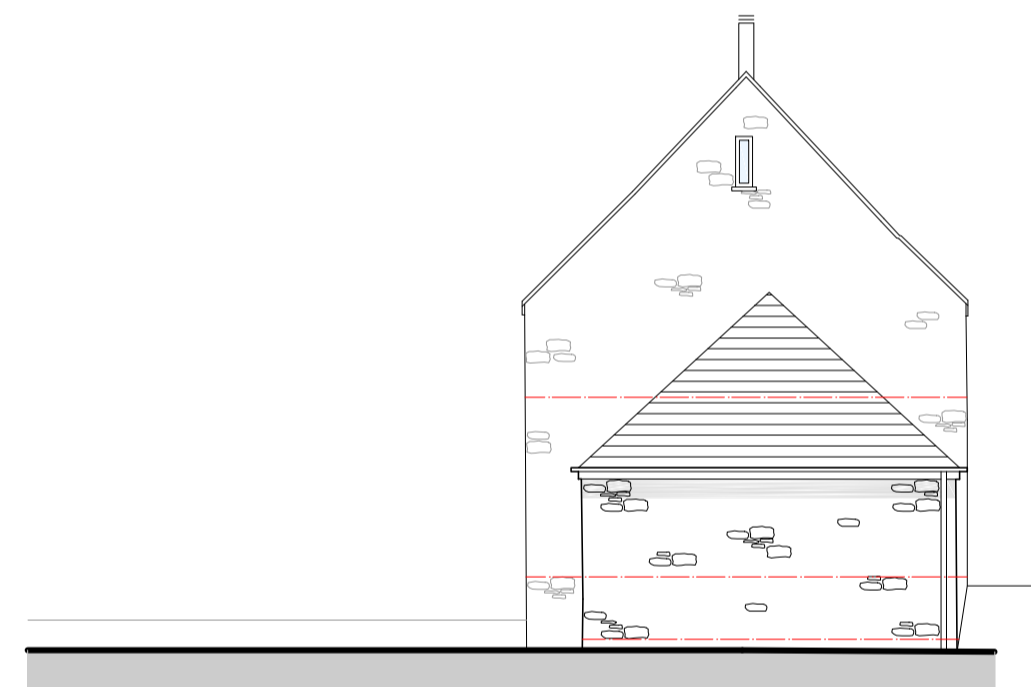

Elevation 3 - As Proposed
(1:100)

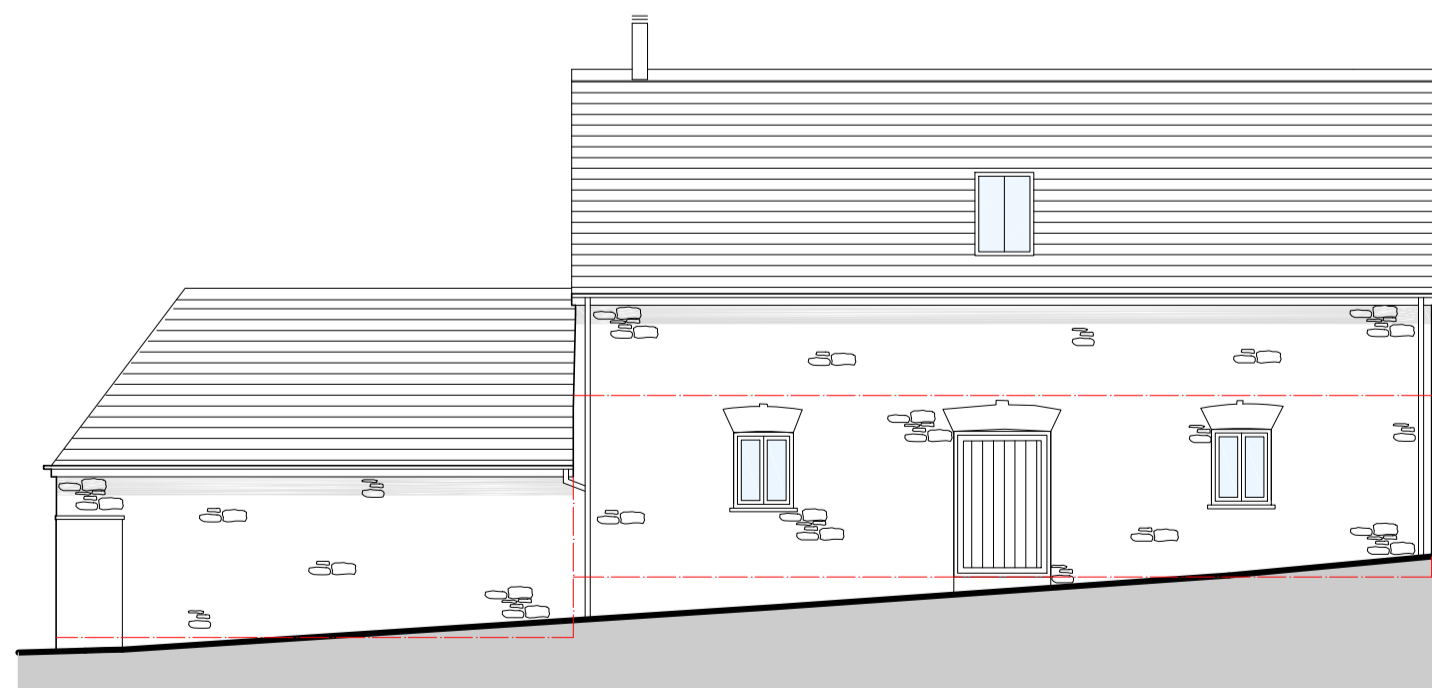

Elevation 4 - As Proposed
(1:100)

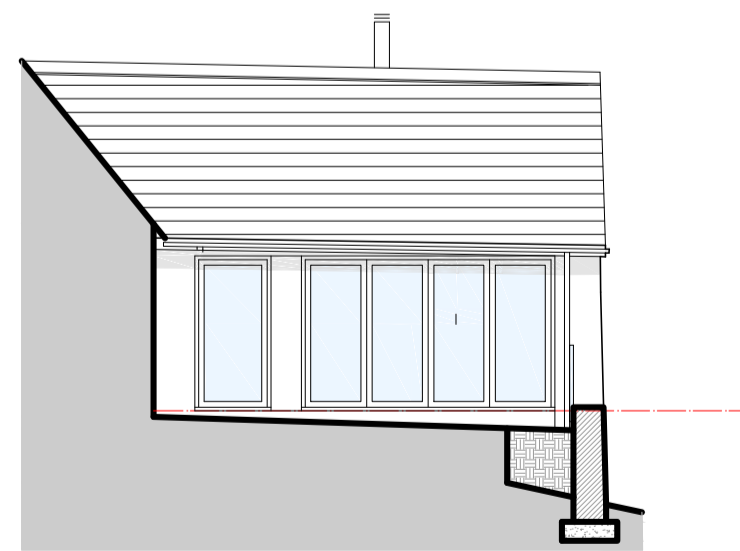

Elevation 5 - As Proposed
(1:100)



Proposed Elevation Location Plan
(Not To Scale)

CURRENT DRAWINGS

| no. | date | description | by |
|-----|----------|----------------------|----|
| A | 27.09.24 | Ridge glazing added. | JO |
| - | 12.09.24 | FIRST ISSUE | JO |

Derry Owen Architects

The Warehouse
Prince of Wales Road
Kingsbridge TQ7 1DY

01548 800345
office@derryowenarchitects.co.uk
www.derryowenarchitects.co.uk

| client | date |
|-----------------------------------|------------|
| Mr G Rood | June 2019 |
| project | scale |
| Norton Farm, Kingsbridge, TQ7 4AE | 1:100 @ A1 |
| drawing | drawn |
| Elevations 1 - 5 'As Proposed' | CJ |
| drawing no. | rev. |
| 2325.50 | A |

